



INFORMATION

The Bimetal Masonry Screw is a A4-316 stainless steel anchor that can cut through base materials including concrete and masonry. It is suitable for use in non-structural applications in environments where durability is critical. The undercutting action provides a positive secure anchorage with no expansion which leads to fast and easy installation.

It could be used for:

- Window and door frames
- Plumbing and electrical fixings
- General components into concrete and masonry

BASE MATERIAL

- Non-Cracked Solid Concrete
- Hard Concrete Block
- Hard Natural Stone
- Solid Brick

FEATURES

- Undercutting Action
- Expansion Free
- Through Fixing
- Fast And Secure Installation
- Reaction to Fire Class A1
- Corrosion Resistance

RELATED PRODUCTS



SD05

SDS+ Drill Bits



BOP1

Hole Cleaning Pump

RANGE AND LOAD DATA

RANGE AND LOAD DATA(C20/25 CONCRETE)

Part Number	Drill Hole Diam	Min Hole Depth	Min Embedment depth	Overall Length	Thread Length	Max Fixture Thickness	Tightening Torque	Recommended Tensile Resistance	Recommended Shear Resistance
	(d_0)	(h_1)	(h_{nom})	(L)	(L1)	(t_{fx})	(T_{inst})	(N_{Re})*	(V_{Re})*
	mm	mm	mm	mm	mm	mm	kN.m	kN	kN
Bi metal Masonry Screws									
MS63045SS	5	40	30	45	45	15	12	1.00	1.5
MS63057SS				57	50	27			
MS63070SS				70	50	40			

* The installation safety factor of 1.4 is included. (1kN=100kg) loads

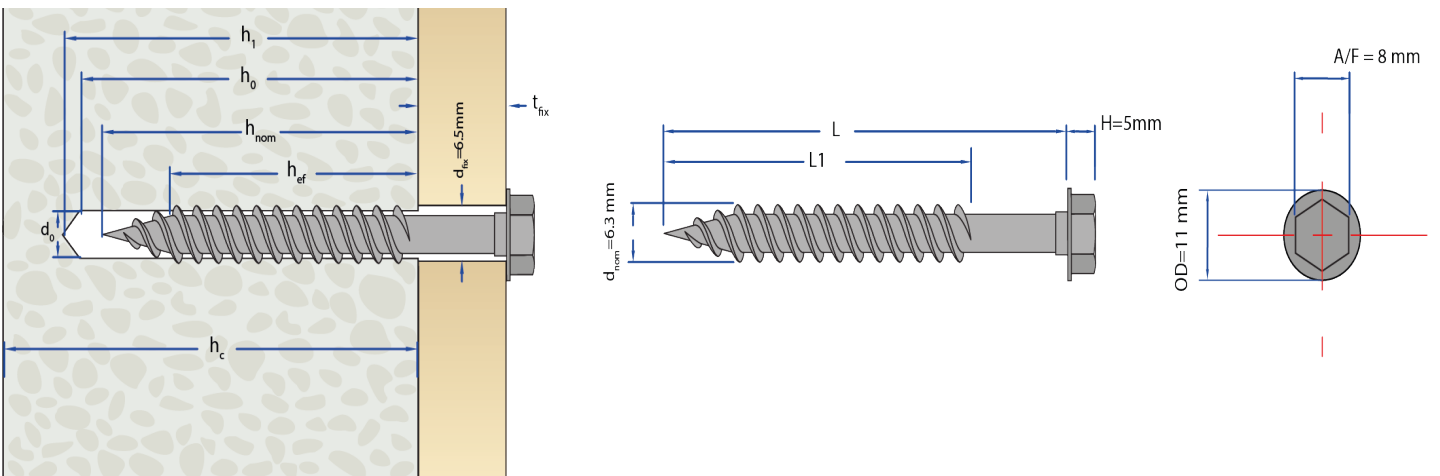

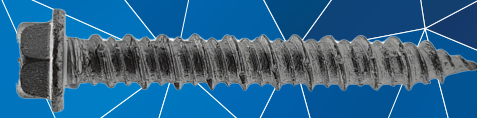

INSTALLATION INSTRUCTIONS

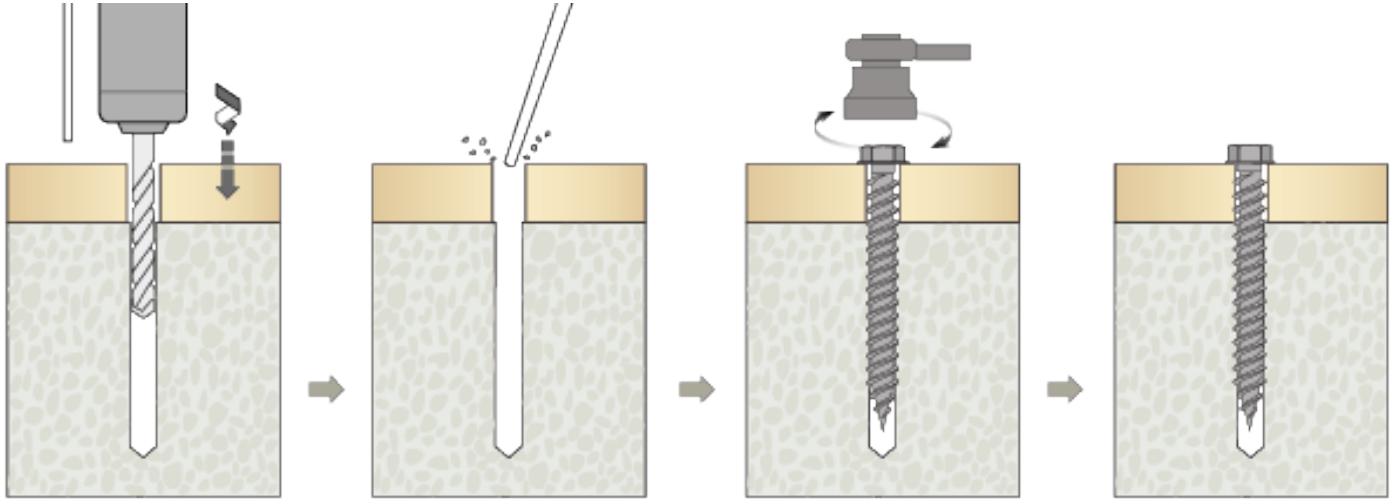

-Drill correct diameter hole to corresponding depth

-Clean hole by brushing and blowing to remove drilling debris and dust

Insert anchor through fixture into concrete and Finish by tightening with torque wrench to recommended torque

