



# JCP CONSTRUCTION PRODUCTS

## Bigtwist Nail

### Bigtwist Nail

A 20mm headed twist nail made from Grade 8.8 steel. Suitable for fixing composite panels to wooden battens.



### Application

Hammer driven fixing for securing composite panels and plywood sheets to timber joists

Part No. Bag	Part No. Box	Anchor Length mm	Maximum Fixture Thickness mm	Qty Per Bag	Qty Per Box
TC08090BG	TC08090BX	90	55	25	500
TC08135BG	TC08135BX	135	100	25	500
TC08165BG	TC08165BX	165	130	25	500
TC08195BG	TC08195BX	195	160	25	300
TC08220BG	TC08220BX	220	185	25	300

#### Benefits:

- ✦ No Drilling required
- ✦ No need for screws
- ✦ Quick installation
- ✦ Rotates during installation to reduce risk of splitting timber
- ✦ Large 20mm head
- ✦ Unique one piece stress free fixing
- ✦ Grade 8.8 High Tensile steel, Zinc Plated and Passivated

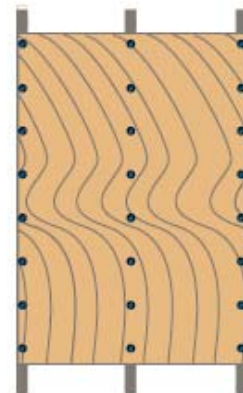

600mm Rafter Spacing requires 300mm Axial Spacing

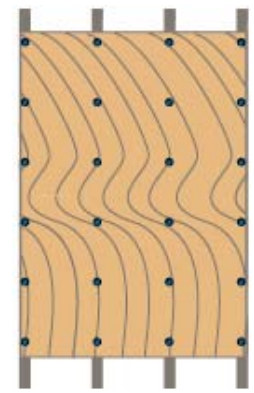

400mm Rafter Spacing requires 400mm Axial Spacing

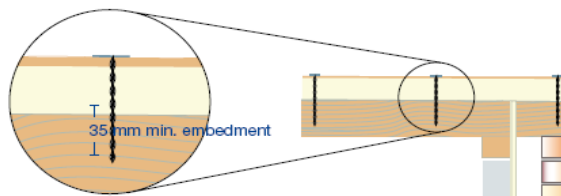
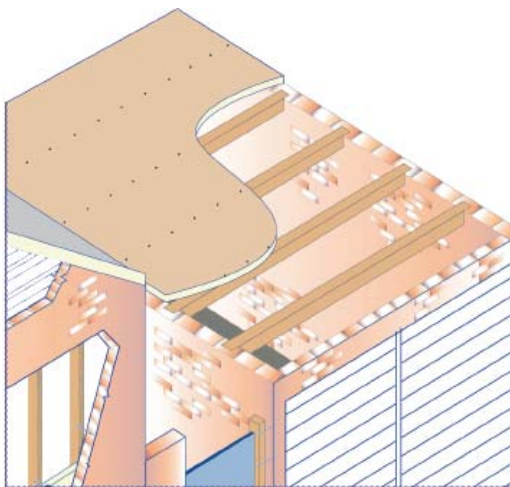

**Average Ultimate Load at 35mm embedment in softwood = 1090N (approx 109kg)**

(Independently tested at Imperial College, London)

Dartford 01322 277733  
 Elland 01422 370121  
 Milton Keynes 01908 330050

Stone 01785 819819  
 Swindon 01793 527829

